

Peter Kwasny GmbH, Heilbronner Strasse 96,
74831 Gundelsheim/Germany
Telephone: +49 (0) 06269-95-0; Fax: +49 (0) 6269-95-80
Internet: www.kwasny.de e-mail info@kwasny.de

2K KTL Repair Paint,
black

Art.-No. 680 028

TECHNOLOGY



SprayMax®

- Wide jet spray (spray pattern is the same as a painting gun)
- High paint yield
- Easy to process
- Constant spray pressure (until the can is completely empty)
- Professional results

PRODUCT

- Simple, time-saving processing
- Colour tone and level of shine adapted to standard black KTL types e.g. BASF Carthoguard CG 570 and 580
- Very good adhesion to black KTL
- Very fine spray and very low spray mist

APPLICATION SCOPE

Recommended for:

Insulating sanded-through areas or other faults in a black cathodic dip primer.

TRIGGERING THE 2K CAN



Shake can thoroughly for 2 minutes from the time you hear the shake balls click.

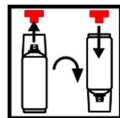

Remove the red pushbutton from the cap. Turn the can by 180° and fit the pushbutton onto the pin in the base of the can.



Turn the can upside down and place on a firm surface. Press the red pushbutton all the way in with the palm of your hand.



After triggering the can, shake thoroughly again for 2 minutes from the time you hear the shake balls click.

PROCESSING

Protective measures:



Personal protection equipment must be worn
Respiratory mask type: A2/P2, protective gloves, e.g. made of latex or nitrile

Safety information:

Ready-to-apply coating substances containing isocyanates may irritate mucous membranes – in particular the respiratory organs – and trigger hypersensitivity reactions. Hypersensitivity may be triggered if the vapours or spray mists are inhaled. Strictly observe all measures required for solvents coats when handling coating substances containing isocyanates. In particular, do not inhale vapours or spray mists. Allergy sufferers, or persons with asthma or respiratory illnesses may not work with coating substances containing isocyanates.

Pre-treatment:



KTL coats that are older than 3 days should be sanded first before applying the SprayMax® 2K KTL Repair Paint.

Preparation:

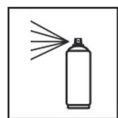

Shake can thoroughly for 2 minutes from the time you hear the shake balls click. Test spray.

Spray coats:

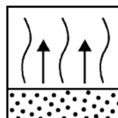

Observe a 5 minute flash-off time between the 2 coats.

Spray distance:

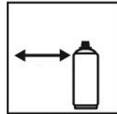

15 – 20 cm

Drying:



The drying times refer to a dry film layer of 40 µm and an ambient temperature of 20 °C

Dust dry: 4 min

Drying level 1 acc. to DIN 53150

Dry to touch: 17 min

Drying level 3 acc. to DIN 53150

Further processing:

Coat with the specified paint layers.

Processing time:

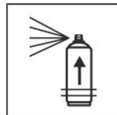

6:30 h at 20 °C room temperature. The processing time depends on the ambient temperature. Higher temperatures will shorten; lower temperatures will lengthen the drying time.

End of work:

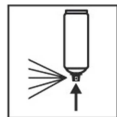

After painting, turn the can upside down and spray until the valve is empty.

Disposal:

The completely empty spray cans can be disposed of in the recycling waste container.

KEY DATA/TECHNICAL PROPERTIES

Raw material base:

Special acrylic resins, hardener: aliphatic isocyanates

Solids content:

approx. 33 weight % in ratio to the diluted paint including hardener, without propellant

VOC value:

655 g/l in relation to the can incl. propellant

Identification:

See safety data sheet

Level of shine:

like KTL surface

Adhesion:

to Catho Guard 570: Gt 0 – 1

to CG 570 after coating with powder (25 min. 200°C): Gt 0 – 1

to CG 570 after coating with 2K-PUR paint: Gt 0 – 1

Salt spray test

200 h layer thickness approx. 30 µm – infiltration 3 mm



TECHNICAL DATA SHEET

Storage stability:



36 months

The usage data refers to unused cans without paint stored correctly at a temperature of 15-25°C and a relative humidity of below 60%. Store and transport the can upright in a dry place protected against chemical or mechanical influences. Observe the safety provisions on the can and all statutory regulations applicable to the storage place.

Comments

For use by professionals only

SprayMax® is a registered trademark of the Peter Kwasny Group.

This information describes our products and the respective application possibilities, and corresponds to our current information status. It does not aim to promise certain properties or suitability for a specific purpose. The warning information on the product labels must be observed. Please also observe any protection rights.